

GEZ..ES

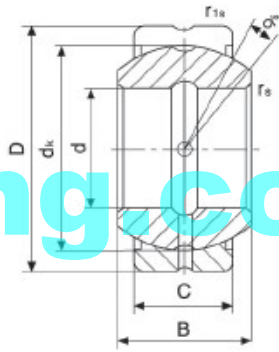

GEZ..ES-2RS

www.mvbbearing.com

Specifications:

- 1) Sliding Contact Surfaces: Steel vs. Steel.
- 2) Materials: Both outer race and inner race are made of high chrome bearing steel.
- 3) Heat treatment: Both outer race and inner race are quenched (hardened), surface phosphorized.
- 4) Features of Structure: With oil groove and oil holes, with an axial split in outer race.
- 5) Lubricant: molybdenum disulfide.
- 6) Properties: Good wearability, corrosion resistance, self-alignment.

MVB Bearing Number		Dimensions (mm)								Load Ratings (KN)		Weight ≈(kg)
Open	Sealed	d	D	B	C	dk	rs min	ris min	α° ≈	Dynamic Cr	Static Cor	
GEZ12ES		12.7	22.23	11.1	9.53	18	0.15	0.6	6	13	41	0.02
		0.500	0.8750	0.4375	0.3750	0.5551	0.006	0.024				
GEZ15ES		15.9	26.99	13.89	11.91	23	0.15	0.6	6	22	65	0.04
		0.625	1.0625	0.5470	0.4690	0.7204	0.006	0.024				
GEZ19ES	GEZ19ES-2RS	19.1	31.75	16.66	14.28	27.5	0.3	0.6	6	31	95	0.05
		0.750	1.2500	0.6560	0.5620	0.8583	0.012	0.024				
GEZ22ES	GEZ22ES-2RS	22.2	36.51	19.43	16.66	32	0.3	0.6	6	42	127	0.09
		0.875	1.4375	0.7650	0.6560	1.0000	0.012	0.024				
GEZ25ES	GEZ25ES-2RS	25.4	41.28	22.23	19.05	36.5	0.3	0.6	6	56	166	0.12
		1.000	1.6250	0.8750	0.7500	1.0866	0.012	0.024				
GEZ31ES	GEZ31ES-2RS	31.8	50.8	27.76	23.8	45.5	0.6	0.6	6	86	260	0.23
		1.250	2.0000	1.0930	0.9370	1.4173	0.024	0.024				
GEZ34ES	GEZ34ES-2RS	34.9	55.56	30.15	26.19	49	0.6	1	6	102	310	0.35
		1.375	2.1875	1.1875	1.0310	1.5197	0.024	0.039				
GEZ38ES	GEZ38ES-2RS	38.1	61.91	33.33	28.58	54.7	0.6	1	6	125	375	0.42
		1.500	2.4375	1.3125	1.1250	1.6221	0.024	0.039				
GEZ44ES	GEZ44ES-2RS	44.5	71.44	38.89	33.33	63.9	0.6	1	6	170	510	0.64
		1.750	2.8125	1.5310	1.3125	1.9961	0.024	0.039				
GEZ50ES	GEZ50ES-2RS	50.8	80.96	44.45	38.1	73	0.6	1	6	224	670	0.93
		2.000	3.1875	1.7500	1.5000	2.2795	0.024	0.039				
GEZ57ES	GEZ57ES-2RS	57.2	90.49	50.01	42.85	82	0.6	1	6	280	850	1.3
		2.250	3.5625	1.9690	1.6875	2.5551	0.024	0.039				
GEZ63ES	GEZ63ES-2RS	63.5	100.01	55.55	47.63	92	1	1	6	355	1060	1.85
		2.500	3.9375	2.1875	1.8750	2.8858	0.039	0.039				
GEZ69ES	GEZ69ES-2RS	69.9	111.13	61.11	52.38	100	1	1	6	415	1250	2.4
		2.750	4.3750	2.4060	2.0625	3.1142	0.039	0.039				
GEZ76ES	GEZ76ES-2RS	76.2	120.65	66.68	57.15	109.5	1	1	6	500	1500	3.1
		3.000	4.7500	2.6250	2.2500	3.4173	0.039	0.039				
GEZ82ES	GEZ82ES-2RS	82.6	130.18	72.24	61.9	119	1	1	6	585	1760	3.8
		3.250	5.1250	2.8440	2.4375	3.7205	0.039	0.039				
GEZ88ES	GEZ88ES-2RS	88.9	139.7	77.78	66.68	128	1	1	6	680	2040	4.8
		3.500	5.5000	3.0625	2.6250	4.0000	0.039	0.039				
GEZ95ES	GEZ95ES-2RS	95.3	149.23	83.34	71.43	137	1	1	6	780	2360	5.8
		3.750	5.8750	3.2810	2.8125	4.2795	0.039	0.039				
GEZ101ES	GEZ101ES-2RS	101.6	158.75	88.9	76.2	146	1	1	6	900	2650	7
		4.000	6.2500	3.5000	3.0000	4.5591	0.039	0.039				

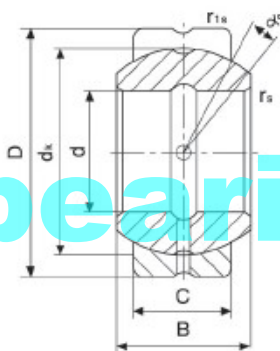
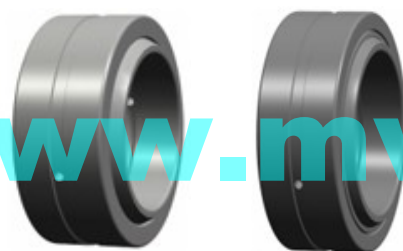

GEZ..ES

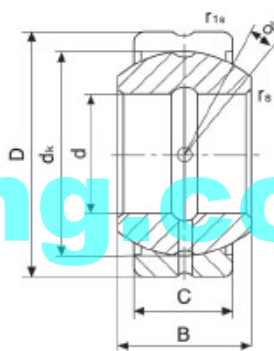

GEZ..ES-2RS

www.mvbbearing.com

Specifications:

- 1) Sliding Contact Surfaces: Steel vs. Steel.
- 2) Materials: Both outer race and inner race are made of high chrome bearing steel.
- 3) Heat treatment: Both outer race and inner race are quenched (hardened), surface phosphorized.
- 4) Features of Structure: With oil groove and oil holes, with an axial split in outer race.
- 5) Lubricant: molybdenum disulfide.
- 6) Properties: Good wearability, corrosion resistance, self-alignment.

MVB Bearing Number		Dimensions (mm)								Load Ratings (KN)		Weight ≈ (kg)
Open	Sealed	d	D	B	C	dk	rs min	ris min	α° ≈	Dynamic Cr	Static Cor	
GEZ107ES	GEZ107ES-2RS	108.0	168.28	94.46	80.95	155	1	1	6	1000	3000	8.41
		4.250	6.6250	3.7190	3.1875	4.8347	0.039	0.039				
GEZ114ES	GEZ114ES-2RS	114.3	177.8	100.01	85.73	164.5	1	1	6	1120	3400	9.8
		4.500	7.0000	3.9375	3.3750	5.1417	0.039	0.039				
GEZ120ES	GEZ120ES-2RS	120.7	187.33	105.56	90.48	173.5	1	1	6	1250	3750	11.5
		4.750	7.3750	4.1560	3.5625	5.4173	0.039	0.039				
GEZ127ES	GEZ127ES-2RS	127.0	196.85	111.13	95.25	183	1	1	6	1400	4150	13.5
		5.000	7.7500	4.3750	3.7500	5.7205	0.039	0.039				
GEZ152ES	GEZ152ES-2RS	152.4	222.25	120.65	104.78	207	1	1	6	1730	5200	17.5
		6.000	8.7500	4.7500	4.1250	6.6221	0.039	0.039				
GEZ165ES	GEZ165ES-2RS	165.1	247.65	123.83	103.19	185.2	1.1	1.1	7	1830	5500	22.900
		6.500	9.7500	4.8750	4.0625	7.2913	0.043	0.043				
GEZ177ES	GEZ177ES-2RS	177.8	266.7	133.35	111.13	199.5	1.1	1.1	7	2120	6390	28.600
		7.000	10.5000	5.2500	4.3750	7.8543	0.043	0.043				
GEZ190ES	GEZ190ES-2RS	190.5	285.75	142.88	119.06	213.7	1.1	1.1	7	2440	7340	35.100
		7.500	11.2500	5.6250	4.6875	8.4134	0.043	0.043				
GEZ203ES	GEZ203ES-2RS	203.2	304.8	152.4	127	228	1.1	1.1	7	2770	8350	42.600
		8.000	12.0000	6.0000	5.0000	8.9764	0.043	0.043				
GEZ215ES	GEZ215ES-2RS	215.9	323.85	161.93	134.94	242.2	1.1	1.1	7	3130	9420	51.100
		8.500	12.7500	6.3750	5.3125	9.5354	0.043	0.043				
GEZ228ES	GEZ228ES-2RS	228.6	342.9	171.45	142.88	256.4	1.1	1.1	7	3510	10500	60.700
		9.000	13.5000	6.7500	5.6250	10.0945	0.043	0.043				
GEZ241ES	GEZ241ES-2RS	241.3	361.95	180.98	150.8	270.7	1.1	1.1	7	3910	11700	71.400
		9.500	14.2500	7.1250	5.9370	10.6575	0.043	0.043				
GEZ254ES	GEZ254ES-2RS	254.0	381	190.5	158.75	284.9	1.1	1.1	7	4340	13050	83.300
		10.000	15.0000	7.5000	6.2500	11.2165	0.043	0.043				
GEZ266ES	GEZ266ES-2RS	266.7	400.05	200.03	166.69	299.2	1.1	1.1	7	4780	14300	96.400
		10.500	15.7500	7.8750	6.5625	11.7795	0.043	0.043				
GEZ279ES	GEZ279ES-2RS	279.4	419.1	209.55	174.63	313.4	1.1	1.1	7	5250	15700	110.800
		11.000	16.5000	8.2500	6.8750	12.3386	0.043	0.043				
GEZ292ES	GEZ292ES-2RS	292.1	438.15	219.08	182.56	327.7	1.1	1.1	7	5740	17200	126.700
		11.500	17.2500	8.6250	7.1875	12.9016	0.043	0.043				
GEZ304ES	GEZ304ES-2RS	304.8	457.2	228.6	190.5	341.9	1.1	1.1	7	6250	18700	143.900
		12.000	18.0000	9.0000	7.5000	13.4606	0.043	0.043				

www.mvbbearing.com

GEZ 008 ES	12,7	22,225	11,1	9,525	6	14	41,5	0,02
GEZ 010 ES	15,875	26,988	13,894	11,913	6	21,6	65,5	0,035
GEZ 012 ES	19,05	31,75	16,662	14,275	6	31,5	93	0,055
GEZ 014 ES	22,225	36,513	19,431	16,662	6	42,5	127	0,085
GEZ 100 ES	25,4	41,275	22,225	19,05	6	56	166	0,12
GEZ 100 ES-2RS	25,4	41,275	22,225	19,05	6	56	166	0,12
GEZ 104 ES	31,75	50,8	27,762	23,8	6	86,5	260	0,23
GEZ 104 ES-2RS	31,75	50,8	27,762	23,8	6	86,5	260	0,23
GEZ 106 ES	34,925	55,563	30,15	26,187	5	104	310	0,35
GEZ 106 ES-2RS	34,925	55,563	30,15	26,187	5	104	310	0,35
GEZ 108 ES	38,1	61,913	33,325	28,575	6	125	375	0,42
GEZ 108 ES-2RS	38,1	61,913	33,325	28,575	6	125	375	0,42
GEZ 112 ES	44,45	71,438	38,887	33,325	6	170	510	0,64
GEZ 112 ES-2RS	44,45	71,438	38,887	33,325	6	170	510	0,64
GEZ 200 ES	50,8	80,963	44,45	38,1	6	224	670	0,93
GEZ 200 ES-2RS	50,8	80,963	44,45	38,1	6	224	670	0,93
GEZ 204 ES	57,15	90,487	50,013	42,85	6	280	850	1,3
GEZ 204 ES-2RS	57,15	90,487	50,013	42,85	6	280	850	1,3
GEZ 208 ES	63,5	100,013	55,55	47,625	6	345	1040	1,85
GEZ 208 ES-2RS	63,5	100,013	55,55	47,625	6	345	1040	1,85
GEZ 212 ES	69,85	111,125	61,112	52,375	6	425	1270	2,4
GEZ 212 ES-2RS	69,85	111,125	61,112	52,375	6	425	1270	2,4
GEZ 300 ES	76,2	120,65	66,675	57,15	6	500	1500	3,1
GEZ 300 ES-2RS	76,2	120,65	66,675	57,15	6	500	1500	3,1
GEZ 304 ES	82,55	130,175	72,238	61,9	6	585	1760	3,8
GEZ 304 ES-2RS	82,55	130,175	72,238	61,9	6	585	1760	3,8
GEZ 308 ES	88,9	139,7	77,775	66,675	6	680	2040	4,8
GEZ 308 ES-2RS	88,9	139,7	77,775	66,675	6	680	2040	4,8
GEZ 312 ES	95,25	149,225	83,337	71,425	6	780	2360	5,8
GEZ 312 ES-2RS	95,25	149,225	83,337	71,425	6	780	2360	5,8
GEZ 400 ES	101,6	158,75	88,9	76,2	6	900	2650	7
GEZ 400 ES-2RS	101,6	158,75	88,9	76,2	6	900	2650	7
GEZ 408 ES	114,3	177,8	100	85,725	6	1120	3400	9,8
GEZ 408 ES-2RS	114,3	177,8	100	85,725	6	1120	3400	9,8
GEZ 412 ES	120,65	187,325	105,562	90,475	6	1250	3750	11,5
GEZ 412 ES-2RS	120,65	187,325	105,562	90,475	6	1250	3750	11,5
GEZ 500 ES	127	196,85	111,125	95,25	6	1400	4150	13,5
GEZ 500 ES-2RS	127	196,85	111,125	95,25	6	1400	4150	13,5
GEZ 600 ES	152,4	222,25	120,65	104,775	5	1730	5200	17,5
GEZ 600 ES-2RS	152,4	222,25	120,65	104,775	5	1730	5200	17,5