

# SBP200 Series

## Pillow Block 帶座外球面軸承



# Mounted Ball Bearing Units

## Wide Inner Race, Set Screw Locking, Normal Duty

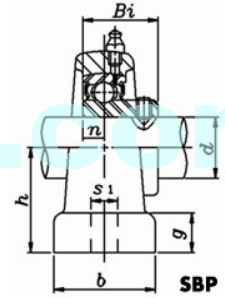
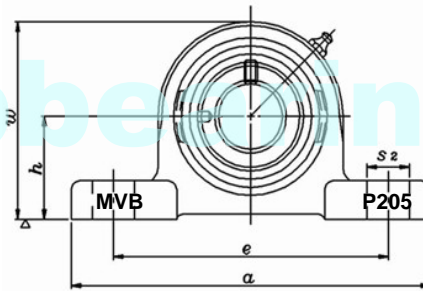

MVB Bearing Unit No.	Shaft Dia.		Dimensions (in./mm)										Bolt Used		Bearing No.	Housing No.	Weight Lbs./kg
	d		h	a	e	b	S2	S1	g	w	Bi	n	Bolt Used				
	in.	(mm)											(mm)	(in.)			
SBP201-08 SBP201	1/2	12	1 3/16 30.2	5 127	3 3/4 95.3	1 1/2 38.1	3/4 19	1/2 12.7	9/16 14	2 7/16 62	0.8661 22	0.2362 6	M10	3/8	SB201-8 SB201	P 203	1.41 0.64
SBP202-9 SBP202	9/16	15	1 3/16 30.2	5 127	3 3/4 95.3	1 1/2 38.1	3/4 19	1/2 12.7	9/16 14	2 7/16 62	0.8661 22	0.2362 6	M10	3/8	SB202-9 SB202	P 203	1.39 0.63
SBP203-11 SBP203	11/16	17	1 3/16 30.2	5 127	3 3/4 95.3	1 1/2 38.1	3/4 19	1/2 12.7	9/16 14	2 7/16 62	0.8661 22	0.2362 6	M10	3/8	SB203-11 SB203	P 203	1.36 0.62
SBP204-12 SBP204	3/4	20	1 5/16 33.3	5 127	3 3/4 95.3	1 1/2 38.1	3/4 19	1/2 12.7	9/16 14	2 17/32 64.3	0.9843 25	0.2756 7	M10	3/8	SB204-12 SB204	P 204	1.43 0.65
SBP205-13 SBP205-14 SBP205-15 SBP205-16 SBP205	13/16 7/8 15/16 1	25	1 7/16 36.5	5 1/2 140	4 1/8 105	1 1/2 38.1	3/4 19	1/2 12.7	19/32 15	2 25/32 70.6	1.0630 27	0.2953 7.5	M10	3/8	SB205-13 SB205-14 SB205-15 SB205-16 SB205	P 205	1.81 0.82
SBP206-17 SBP206-18 SBP206-19 SBP206-20 SBP206	1-1/16 1-1/8 1-3/16 1-1/4	30	1 11/16 42.9	6 1/2 165	4 3/4 120.7	1 7/8 47.6	25/32 20	21/32 16.7	21/32 16.7	3 5/16 84.1	1.1811 30	0.3150 8	M14	1/2	SB206-17 SB206-18 SB206-19 SB206-20 SB206	P 206	2.89 1.31
SBP207-20 SBP207-21 SBP207-22 SBP207-23 SBP207	1-1/4 1-5/16 1-3/8 1-7/16	35	1 7/8 47.6	6 9/16 167	5 127	1 7/8 47.6	25/32 20	21/32 16.7	45/64 18	3 21/32 92.9	1.2598 32	0.3346 8.5	M14	1/2	SB207-20 SB207-21 SB207-22 SB207-23 SB207	P 207	3.57 1.62
SBP208-24 SBP208-25 SBP208	1-1/2 1-9/16	40	1 15/16 49.2	7 1/4 184	5 13/32 137.3	2 1/8 54	25/32 20	21/32 16.7	45/64 18	3 27/32 97.6	1.3386 34	0.3543 9	M14	1/2	SB208-24 SB208-25 SB208	P 208	4.50 2.04
SBP209-26 SBP209-27 SBP209-28 SBP209	1-5/8 1-11/16 1-3/4	45	2 1/8 54.0	7 15/32 190	5 3/4 146	2 1/8 54	25/32 20	21/32 16.7	25/32 20	4 3/16 106.4	1.6220 41.2	0.3740 9.5	M14	1/2	SB209-26 SB209-27 SB209-28 SB209	P 209	5.25 2.38
SBP210-29 SBP210-30 SBP210-31 SBP210-32 SBP210	1-13/16 1-7/8 1-15/16 2	50	2 1/4 57.2	8 1/8 206	6 1/4 159	2 3/8 60.3	29/32 23	25/32 19.8	53/64 21	4 7/16 112.7	1.6378 41.6	0.3937 10	M16	5/8	SB210-29 SB210-30 SB210-31 SB210-32 SB210	P 210	6.11 2.77
SBP211-32 SBP211-33 SBP211-34 SBP211-35 SBP211	2 2-1/16 2-1/8 2-3/16	55	2 1/2 63.5	8 5/8 219	6 23/32 170.7	2 3/8 60.3	29/32 23	25/32 19.8	29/32 23	4 29/32 124.6	1.7835 45.3	0.4646 11.8	M16	5/8	SB211-32 SB211-33 SB211-34 SB211-35 SB211	P 211	7.63 3.46
SBP212-36 SBP212-37 SBP212-38 SBP212-39 SBP212	2-1/4 2-5/16 2-3/8 2-7/16	60	2 3/4 69.8	9 1/2 241	7 1/4 184.2	2 3/4 70	29/32 23	25/32 19.8	63/64 25	5 7/16 138.1	2.1142 53.7	0.7835 19.9	M16	5/8	SB212-36 SB212-37 SB212-38 SB212-39 SB212	P 212	10.67 4.84

NOTE: 1. Grease Fittings available at 90° and 45° positions.