

# Self-aligning Ball Bearings

## 调心球轴承

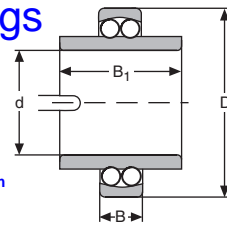

**XMVB Power-Star Bearing Co.**  
 Url: www.mvbbearing.com  
 Email: vivy@mvbbearing.com  
 mvbbearing@gmail.com  
 Tel: +86-592-523 0986  
 Fax: +86-592-376 1975



11200 Series

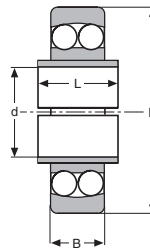

11500 Series

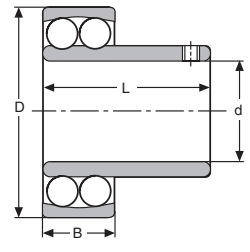

I-71200 Series

### SELF-ALIGNING BALL BEARINGS - EXTENDED INNER RING

No.	Dimensions (Metric)				Approx. Wgt. (lbs.)	Interchange			
	d	D	B	B1		FAG	MRC	SKF	STEYR
11204	20	47	14	40	.400	11204TVH	11204E	11204ETN9	11204
11205	25	52	15	44	.490	11205TVH	11205E	11205ETN9	11205
11206	30	62	16	48	.780	11206TVH	11206E	11206TN9	11206
11207	35	72	17	52	1.190	11207TVH	11207E	11207TN9	11207
11208	40	80	18	56	1.590	11208TVH	11208E	11208TN9	11208
11209	45	85	19	58	1.700	11209TVH	11209E	11209TN9	11209
11210	50	90	20	58	1.870	11210TVH	11210E	11210TN9	11210
11211	55	100	21	60	2.490	11211TVH	11211E	11211TN9	11211
11212	60	110	22	62	3.310	11212TVH	11212E	11212TN9	11212
11305	25	62	17	48	.910	-	11305E	-	11305
11306	30	72	19	52	1.340	-	11306E	-	11306
11307	35	80	21	56	1.790	-	11307E	-	11307
11308	40	90	23	58	2.380	-	11308E	-	11308
11309	45	100	25	60	3.090	-	11309E	-	11309
11310	50	110	27	62	3.880	-	11310E	-	11310

### SELF-ALIGNING BALL BEARINGS - WITH TAPERED SLEEVE

No.	Dimensions (Metric)				Approx. Wgt. (lbs.)	Interchange			
	d	D	B	L		FAG	MRC	SKF	STEYR
11504	20	47	14	23	.270	11504	-	11504	11504
11505	25	52	15	25	.320	11505	-	11505	11505
11506	30	62	16	25	.510	11506	-	11506	11506
11507	35	72	17	26	.740	11507	-	11507	11507
11508	40	80	18	27	.960	11508	-	11508	11508
11509	45	85	19	28	1.060	11509	-	11509	11509
11510	50	90	20	30	1.190	11510	-	11510	11510

NOTE:

- 1.) Tapered sleeve has a 1:17 taper.
- 2.) Allowable misalignment 4°.

### SELF-ALIGNING BALL BEARINGS - EXTENDED INNER RING

No.	Dimensions (Metric)				Approx. Wgt. (lbs.)	Interchange	
	d	D	B	L		FED	SKF
I-71212	.7500	47	14	1.5880	.500	I-71212	
I-71213	.8125	52	15	1.6080	.560	I-71213	
I-71214	.8750	52	15	1.6080	.500	I-71214	
I-71215	.9375	52	15	1.6080	.430	I-71215	
I-71216	1.0000	52	15	1.6080	.430	I-71216	
I-71217	1.0625	62	16	1.6900	.870	I-71217	
I-71218	1.1250	62	16	1.6900	.810	I-71218	
I-71219	1.1875	62	16	1.6900	.750	I-71219	
I-71220	1.2500	72	17	1.8350	1.180	I-71220	
I-71221	1.3125	72	17	1.8350	1.120	I-71221	
I-71222	1.3750	72	17	1.8350	1.120	I-71222	
I-71223	1.4375	72	17	1.8350	1.060	I-71223	
I-71224	1.5000	80	18	1.8540	1.560	I-71224	
I-71225	1.5625	80	18	1.8540	1.500	I-71225	
I-71226	1.6250	85	19	2.0000	1.680	I-71226	
I-71227	1.6875	85	19	2.0000	1.620	I-71227	
I-71228	1.7500	85	19	2.0000	1.560	I-71228	
I-71229	1.8125	90	20	2.1440	2.120	I-71229	
I-71230	1.8750	90	20	2.1440	2.060	I-71230	
I-71231	1.9375	90	20	2.1440	2.000	I-71231	
I-71232	2.0000	100	21	2.1630	2.870	I-71232	
I-71233	2.0625	100	21	2.1630	2.750	I-71233	
I-71234	2.1250	100	21	2.1630	2.620	I-71234	
I-71235	2.1875	100	21	2.1630	2.500	I-71235	

NOTE:

- 1.) Extended inner ring equipped with two set screws 120° apart.
- 2.) Allowable misalignment 4°.